

IXCONNECT PLUG IN SUPPORTS FOR GLASS SHELVES

Glass shelf support, plug in, for Ø 3 mm holes

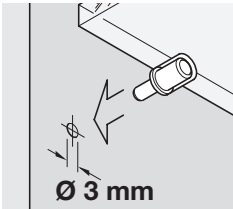

- > For Ø 3 mm hole
- > Load carrying capacity 80 kg
- > Steel with transparent plastic cap
- > Order qty: Multiples of 100 pcs

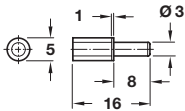

Finish	Cat. No.
Galvanized	281.40.712

Glass shelf support, plug in, for Ø 3 mm holes

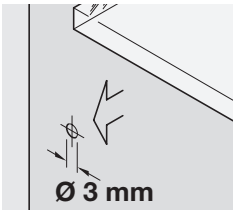

- > For Ø 3 mm hole
- > For 5 mm shelf thickness
- > Plastic with nickel-plated steel pin
- > Order qty: Multiples of 100 pcs

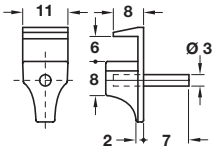

Finish	Cat. No.
Transparent	287.26.453

TCH TECHNOLOGY 2018, © Häfele U.K. Ltd 2018. Dimensional data not binding. We reserve the right to alter specifications without notice.